

# ERSSB 12-X - 9.6mm (3/8") Round Head Lock Bolt

Unit:mm/ (inch)

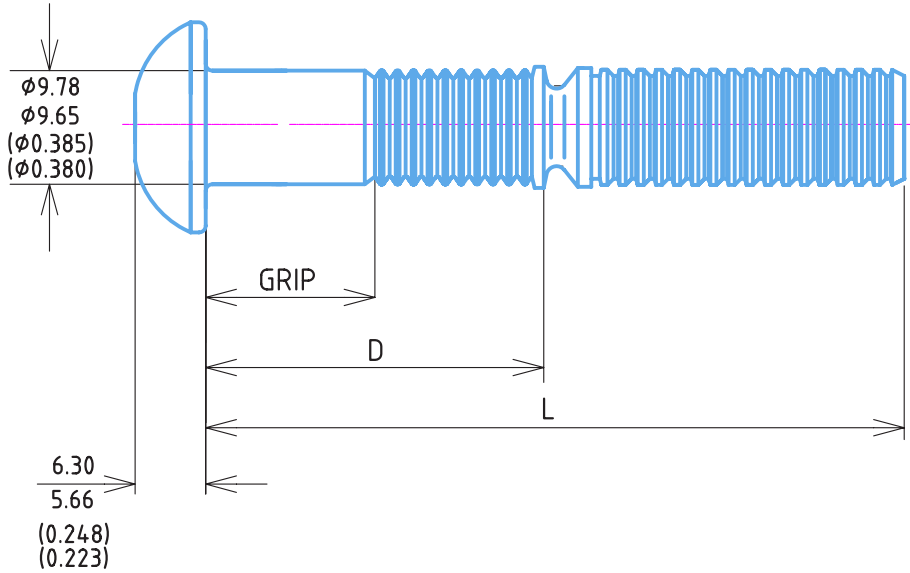

Letter Showing:  
Min-Max Grip Range

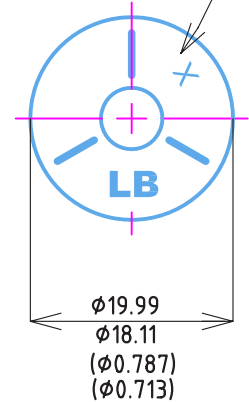

## Technical Requirements

Min Ultimate Tensile:	27.1 (KN)	Clamping Load:	17.8 (KN)
Min Shear Strength:	35.3 (KN)	Surface Treatment:	SS304
Max Hole Diameter:	9.8 (mm)	Raw Material Specification:	Bright

3/8"	Part Number	Grip (mm)		Grip (inch)		D (mm)		D (inch)		L (mm)		L (inch)		Head Marking
		Min	Max	Min	Max	Min	Max	Min	Max	Min	Max	Min	Max	
12-4	ERSSB12-04	3.18	9.53	0.125	0.375	19.75	21.35	0.778	0.841	53.87	55.37	2.121	2.180	4
12-6	ERSSB12-06	6.35	12.70	0.250	0.500	22.92	24.52	0.902	0.965	57.05	58.55	2.246	2.305	6
12-8	ERSSB12-08	9.53	15.88	0.375	0.625	26.10	27.70	1.028	1.091	60.22	61.72	2.371	2.430	8
12-10	ERSSB12-10	12.70	19.05	0.500	0.750	29.27	30.87	1.152	1.215	63.40	64.90	2.496	2.555	10
12-12	ERSSB12-12	15.88	22.23	0.625	0.875	32.45	34.05	1.278	1.341	66.57	68.07	2.621	2.680	12
12-14	ERSSB12-14	19.05	25.40	0.750	1.000	35.62	37.22	1.402	1.465	69.75	71.25	2.746	2.805	14
12-16	ERSSB12-16	22.23	28.58	0.875	1.125	38.80	40.40	1.528	1.591	72.92	74.42	2.871	2.930	16
12-18	ERSSB12-18	25.40	31.75	1.000	1.250	41.97	43.57	1.652	1.715	76.10	77.60	2.996	3.055	18
12-20	ERSSB12-20	28.58	34.93	1.125	1.375	45.15	46.75	1.778	1.841	79.27	80.77	3.121	3.180	20