

# ERSCSK06-XG-4.8mm(3/16") Countersunk Lock Bolt

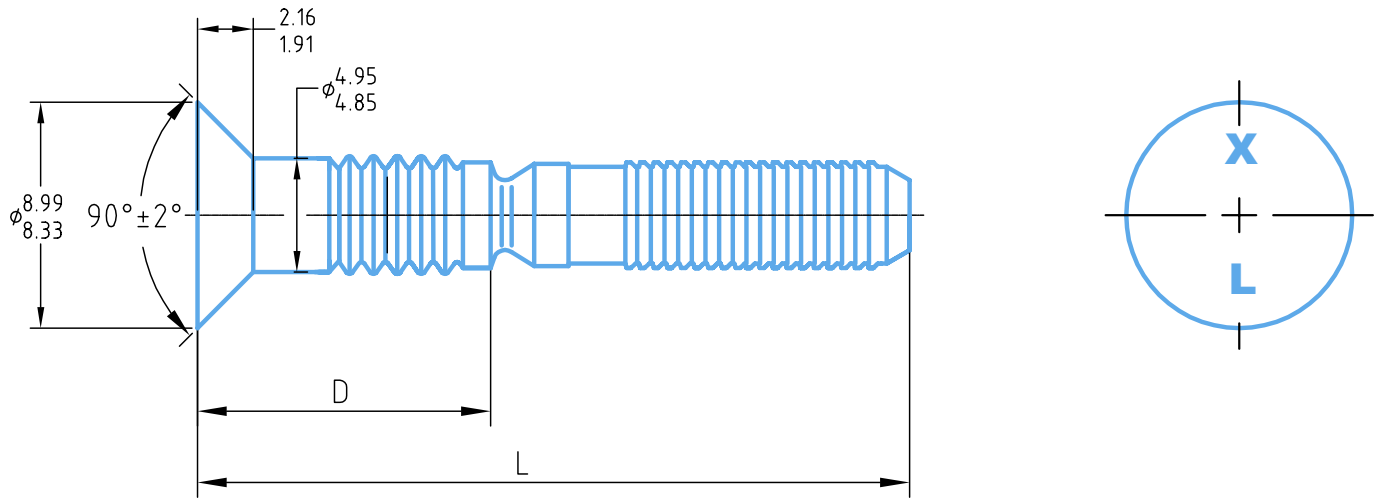

## Technical Requirements

Min Ultimate Tensile:	7.3 (KN)	Clamping Load:	4.57 (KN)
Min Shear Strength:	7.6 (KN)	Surface Treatment:	10 µm Zinc Clear
Max Hole Diameter:	5.0 (mm)	Raw Material Specification:	Carbon Steel

3/16"	Part Number	Grip (mm)		Grip (inch)		D (mm)		D (inch)		L (mm)		L (inch)		Head Marking
		Min	Max	Min	Max	Min	Max	Min	Max	Min	Max	Min	Max	
6-2	ERSCSK06-02G	1.6	4.78	0.063	0.188	9.21	10.81	0.363	0.426	35.66	37.16	1.404	1.463	2
6-3	ERSCSK06-03G	3.18	6.35	0.125	0.25	10.81	12.41	0.426	0.489	37.24	38.74	1.466	1.525	3
6-4	ERSCSK06-04G	4.78	7.95	0.188	0.313	12.38	13.98	0.487	0.55	38.84	40.34	1.529	1.588	4
6-5	ERSCSK06-05G	6.35	9.53	0.25	0.375	13.98	15.58	0.55	0.613	40.41	41.91	1.591	1.65	5
6-6	ERSCSK06-06G	7.95	11.13	0.313	0.438	15.56	17.16	0.613	0.676	42.01	43.51	1.654	1.713	6
6-7	ERSCSK06-07G	9.53	12.7	0.375	0.5	17.16	18.76	0.676	0.739	43.59	45.09	1.716	1.775	7
6-8	ERSCSK06-08G	11.13	14.3	0.438	0.563	18.73	20.33	0.737	0.8	45.19	46.69	1.779	1.838	8
6-9	ERSCSK06-09G	12.7	15.88	0.5	0.625	20.33	21.93	0.8	0.863	46.76	48.26	1.841	1.9	9
6-10	ERSCSK06-10G	14.3	17.48	0.563	0.688	21.91	23.51	0.863	0.926	48.36	49.86	1.904	1.963	10
6-11	ERSCSK06-11G	15.88	19.05	0.625	0.75	23.51	25.11	0.926	0.989	49.94	51.44	1.966	2.025	11
6-12	ERSCSK06-12G	17.48	20.65	0.688	0.813	25.08	26.68	0.987	1.05	51.54	53.04	2.029	2.088	12
6-13	ERSCSK06-13G	19.05	22.23	0.75	0.875	26.68	28.28	1.05	1.113	53.11	54.61	2.091	2.15	13
6-14	ERSCSK06-14G	20.65	23.83	0.813	0.938	28.26	29.86	1.113	1.176	54.71	56.21	2.154	2.213	14
6-15	ERSCSK06-15G	22.23	25.4	0.875	1	29.86	31.46	1.176	1.239	56.29	57.79	2.216	2.275	15
6-16	ERSCSK06-16G	23.83	27	0.938	1.063	31.43	33.03	1.237	1.3	57.89	59.39	2.279	2.338	16
6-17	ERSCSK06-17G	25.4	28.58	1	1.125	33.03	34.63	1.3	1.363	59.46	60.96	2.341	2.4	17
6-18	ERSCSK06-18G	27	30.18	1.063	1.188	34.61	36.21	1.363	1.426	61.06	62.56	2.404	2.463	18
6-19	ERSCSK06-19G	28.58	31.75	1.125	1.25	36.21	37.81	1.426	1.489	62.64	64.14	2.466	2.525	19
6-20	ERSCSK06-20G	30.18	33.35	1.188	1.313	37.78	39.38	1.487	1.55	64.24	65.74	2.529	2.588	20