

ERSB 32-XG - 25.4mm (1") Round Head Lock Bolt

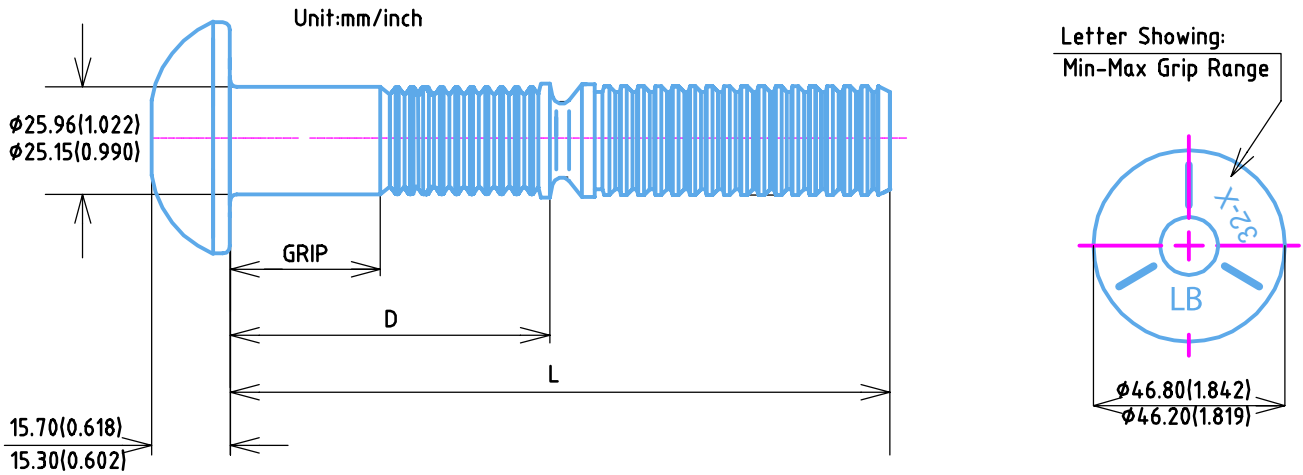

Technical Requirements

Min Ultimate Tensile:	323 (KN)	Max Pin Protusion:	9.5mm
Clamping Load:	229 (KN)	Max Pin Intrusion:	1.6mm
Min Shear Strength:	251 (KN)	Surface Treatment:	10 µm Zinc Clear
Max Hole Diameter:	27 (mm)	Raw Material Specification:	Carbon Steel

1"	Part Number	Grip (mm)		Grip (inch)		D (mm)		D (inch)		L (mm)		L (inch)		Head Marking
		Min	Max	Min	Max	Min	Max	Min	Max	Min	Max	Min	Max	
32-08	ERSB32-08G	12.7	19.05	0.5	0.75	52.05	53.25	2.05	2.1	135.03	139.53	5.32	5.49	32-8
32-12	ERSB32-12G	19.05	25.4	0.75	1	58.4	59.6	2.3	2.35	141.38	145.88	5.57	5.74	32-12
32-16	ERSB32-16G	25.4	31.75	1	1.25	64.75	65.95	2.55	2.6	147.73	152.23	5.82	5.99	32-16
32-20	ERSB32-20G	31.75	38.1	1.25	1.5	71.1	72.3	2.8	2.85	154.08	158.58	6.07	6.24	32-20
32-24	ERSB32-24G	38.1	44.45	1.5	1.75	77.45	78.65	3.05	3.1	160.43	164.93	6.32	6.49	32-24
32-28	ERSB32-28G	44.45	50.8	1.75	2	83.8	85	3.3	3.35	166.78	171.28	6.57	6.74	32-28
32-32	ERSB32-32G	50.8	57.15	2	2.25	90.15	91.35	3.55	3.6	173.13	177.63	6.82	6.99	32-32
32-36	ERSB32-36G	57.15	63.5	2.25	2.5	96.5	97.7	3.8	3.85	179.48	183.98	7.07	7.24	32-36
32-40	ERSB32-40G	63.5	69.85	2.5	2.75	102.85	104.05	4.05	4.1	185.83	190.33	7.32	7.49	32-40
32-44	ERSB32-44G	69.85	76.2	2.75	3	109.2	110.4	4.3	4.35	192.18	196.68	7.57	7.74	32-44
32-48	ERSB32-48G	76.2	82.55	3	3.25	115.55	116.75	4.55	4.6	198.53	203.03	7.82	7.99	32-48
32-52	ERSB32-52G	82.55	88.9	3.25	3.5	121.9	123.1	4.8	4.85	204.9	209.4	8.07	8.24	32-52
32-56	ERSB32-56G	88.9	95.25	3.5	3.75	128.3	129.5	5.05	5.1	211.2	215.7	8.31	8.49	32-56
32-60	ERSB32-60G	95.25	101.6	3.75	4	134.6	135.8	5.3	5.35	217.6	222.1	8.57	8.74	32-60
32-64	ERSB32-64G	101.6	107.95	4	4.25	141	142.2	5.55	5.6	223.9	228.4	8.81	8.99	32-64
32-68	ERSB32-68G	107.95	114.3	4.25	4.5	147.3	148.5	5.8	5.85	230.3	234.8	9.07	9.24	32-68
32-72	ERSB32-72G	114.3	120.65	4.5	4.75	153.7	154.9	6.05	6.1	236.6	241.1	9.31	9.49	32-72
32-76	ERSB32-76G	120.65	127	4.75	5	160	161.2	6.3	6.35	242.98	247.48	9.57	9.74	32-76