

# Roller rods UM1413 (14)(03)(04) series

## Standard lengths or supplied as required

Standard lengths are available from stock or customer defined sizes that can be produced on request.

- Stainless steel 304 or mild steel zinc plated with polyamide rollers
- Can be connected to two, three or four point cams
- Rod length (various) is defined as the dimension from the centre of the eyelet to the end point



## Supply features

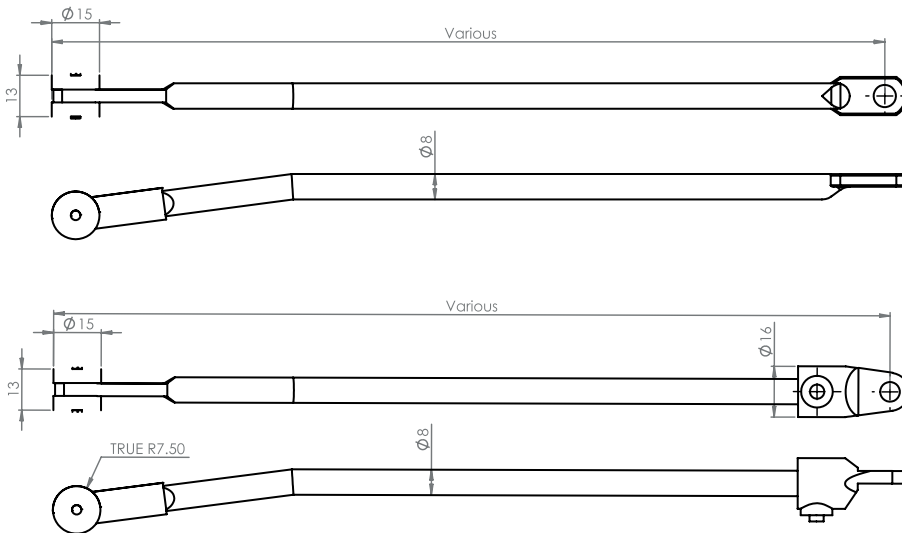

Standard Length	Stainless steel For adaptors	Stainless steel With pressed eyelet	Mild steel zinc plated For adaptors	Mild steel zinc plated With pressed eyelet
600mm	UM1413-600	UM1414-600	UM1403-600	UM1404-600
700mm	UM1413-700	UM1414-700	UM1403-700	UM1404-700
800mm	UM1413-800	UM1414-800	UM1403-800	UM1404-800
900mm	UM1413-900	UM1414-900	UM1403-900	UM1404-900
1000mm	UM1413-1000	UM1414-1000	UM1403-1000	UM1404-1000

## Rod adapters

Supplied separately

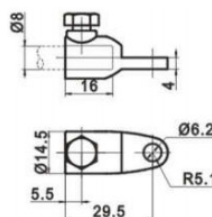

Stainless steel	Mild steel zinc plated
UM1415	UM1405